

# 56314981 BATTERY WATERING KIT

# 56601527 BATTERY WATERING KIT

## CONTENTS OF KIT

ITEM	PART NO.	QTY	DESCRIPTION
	56040853	1	Instruction Sheet
A	56314974	1	Battery Watering System (56314981)
1	56314978	1	Pump
2	56314979	1	Manifold Assy
B	56601526	1	Battery Watering System (56601527)
1	56314978	1	Pump
2	56601525	1	Manifold Assy



Where Unsung Heroes Make It Happen™

800.647.2737 [NationalEW.com](http://NationalEW.com)

Wholesale Parts Pricing

## INSTALLATION INSTRUCTIONS

**NOTE!** This kit can only be used on models using US Battery brand batteries of the following part numbers; 56206079, 56391391 & 56388582.

### **WARNING!**

DISCONNECT BATTERIES BEFORE SERVICING.

### **WARNING!**

Use extreme caution when working with batteries. Sulfuric acid in batteries can cause severe injury if allowed to contact the skin or eyes. Explosive hydrogen gas is vented from the batteries through openings in the battery caps. This gas can be ignited by any electrical arc, spark or flame. Do not install any lead-acid battery in a sealed container or enclosure. Hydrogen gas from overcharging must be allowed to escape.

#### When Servicing Batteries...

- \* Remove all jewelry
- \* Do not smoke
- \* Wear safety glasses, rubber gloves and a rubber apron
- \* Work in a well-ventilated area
- \* Do not allow tools to touch more than one battery terminal at a time
- \* ALWAYS disconnect the negative (ground) cable first when replacing batteries to prevent sparks.
- \* ALWAYS connect the negative cable last when installing batteries.

### **CAUTION!**

Electrical components in this machine can be severely damaged if the batteries are not installed and connected properly. Nilfisk-Advance, a qualified electrician, or the battery manufacturer should install batteries.

**1 See Figure 1 for the most common 6 battery, 36 volt configuration.**

**See Figure 2 for the most common 4 battery, 24 volt configuration.**

Install the Battery Caps (**B**) from the kit. Install the Manifolds (**C**) from the kit as shown. **NOTE:** Make sure the manifolds are pushed all the way down into the Battery Caps.

**2** Measure, cut and install the black rubber Tubes (**D**) as shown.

**3** Install Hose Assy (**E**) as shown. **NOTE:** Coil up on top of the battery pack for storage.

**4** Install Red Caps (**F**) on the remaining barbs as shown.

#### OPERATION

**5** Connect the Pump (**1**) to Hose Assy (**E**) as shown.

**6** Hang other end of Pump Assy (**1**) into container of demineralized water.

**7** Repeatedly squeeze and release the bulb until it offers resistance. **NOTE:** As each battery cell becomes full a shut off valve closes in it's battery cap. Once all of the valves are closed the pump bulb will feel hard since it can no longer pump water.

**8** The Pump Assy (**1**) can be left connected and coiled up on top of the battery pack.

#### NOTE:

The installation instructions provided here is for the most commonly used configuration. In general the pump assembly should be connected to the manifold closest to the center of the battery watering system pipeline as possible.

**FIGURE 1 - TYPICAL 6 BATTERY, 36 VOLT CONFIGURATION**

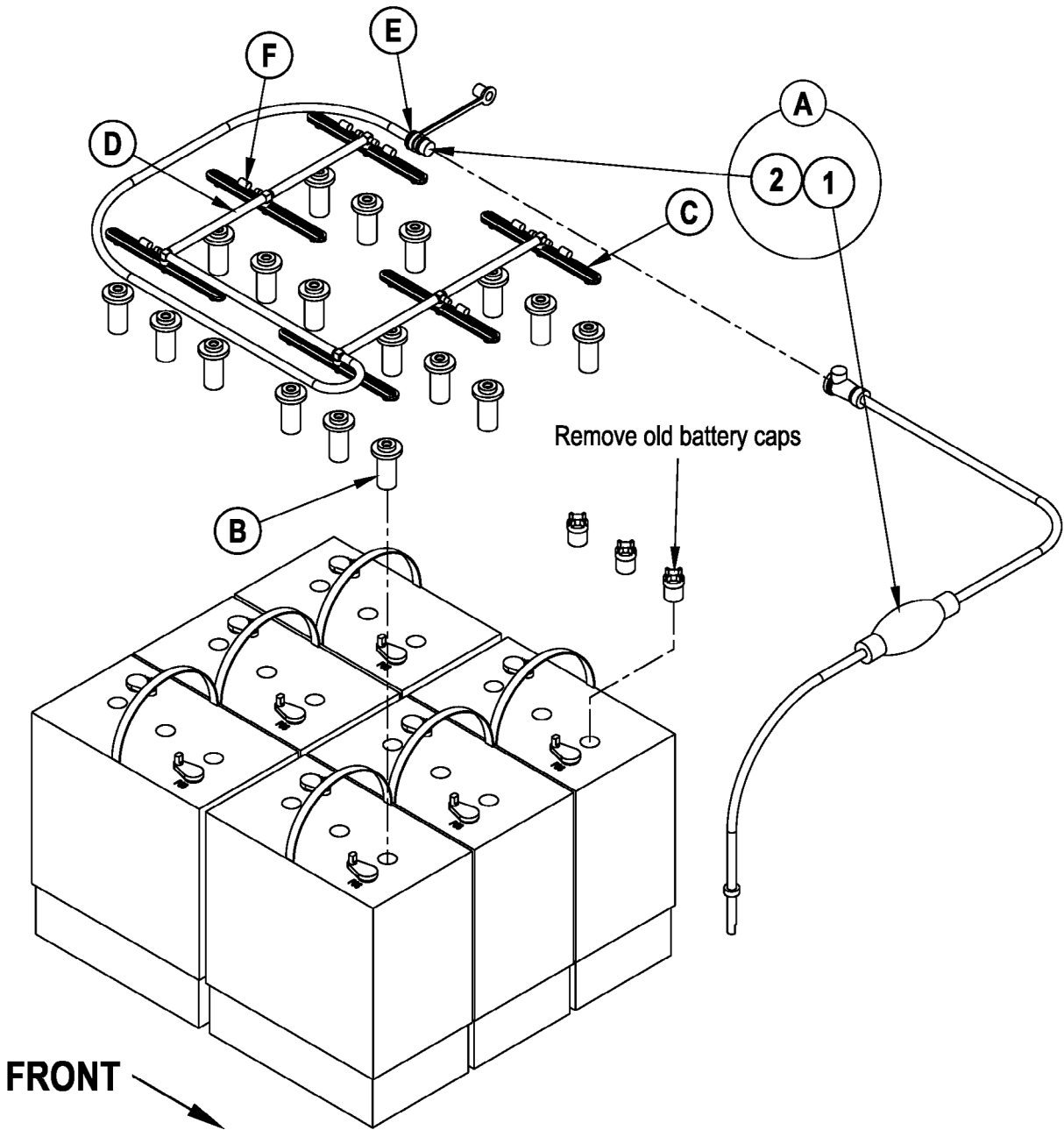

**FIGURE 2 - TYPICAL 4 BATTERY, 24 VOLT CONFIGURATION**

