

EasyNap[®] IN-COUNTER INSTALLATION INSTRUCTIONS

- 1** An opening of 5.5" x 7.5" is required in the countertop for placement of this dispenser. *(We recommend professional installation services.)* Installation location must provide at least 21" of clearance below the countertop for the dispenser chute. *(Not drawn to scale.)*

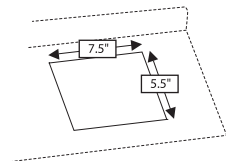

Where Unsung Heroes Make It Happen[™]

800.647.2737

NationalEW.com

- 2** Insert the EasyNap[®] unit into the opening.

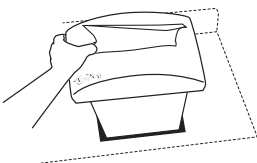

- 3** Open the faceplate by locating the hidden latch and sliding it toward the opening. The hidden latch is located on the under side of the faceplate on the same side as the EasyNap[®] logo.

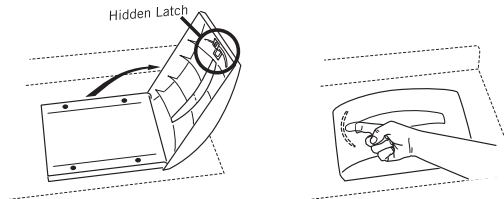

- 4** *Optional:* Install screws (not included) through the four, notched holes of the dispenser.

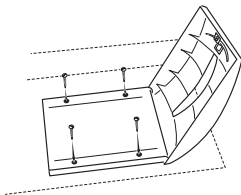

- 5** Load up to 5 packages of EasyNap[®] napkins and close the faceplate. For best operation do not overfill.

